

4517 AYLESBURY DR - Property Map and Details Report

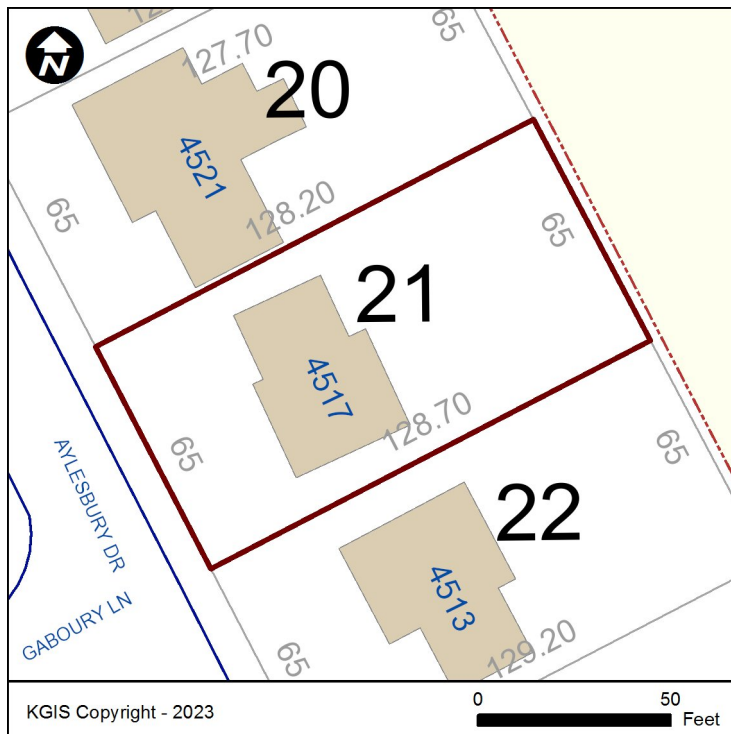

Property Information

Parcel ID: 049NA021
 Location Address: 4517 AYLESBURY DR
 CLT Map: 49
 Insert: N
 Group: A
 Condo Letter:
 Parcel: 21
 Parcel Type: NORMAL DISJ
 District: N7
 Ward:
 City Block:
 Subdivision: WYNGATE S/D UNIT 2
 Rec. Acreage: 0
 Calc. Acreage: 0
 Recorded Plat: 19991102 - 0034670
 Recorded Deed: 20060426 - 0089639
 Deed Type: Deed:Deed
 Deed Date: 4/26/2006

Address Information

Site Address: 4517 AYLESBURY DR
 KNOXVILLE - 37918
 Address Type: DWELLING, SINGLE-FAMILY
 Site Name: WYNGATE
 Please contact Knoxville-Knox County Planning at (865) 215-2500 if you have questions.

Jurisdiction Information

County: KNOX COUNTY
 City / Township:

Political Districts

Voting Precinct: 74
 Voting Location: Shannondale Elementary School
 5316 SHANNONDALE RD
 TN State House: 16
 TN State Senate: 6

Owner Information

THOMAS BRUCE C & KAREN H
 4517 AYLESBURY DR
 KNOXVILLE TN 37918
 The owner information shown in this section does **not** necessarily reflect the person(s) responsible for Last Year's property taxes. Report any errors to the Knox County Property Assessor's office at (865) 215-2365.

Other Information

Census Tract: 43
 Planning Sector: North City
 Please contact Knoxville-Knox County Planning at (865) 215-2500 if you have questions.

School Zones

Elementary: SHANNONDALE ELEMENTARY
 Intermediate:
 Middle: GRESHAM MIDDLE
 High: CENTRAL HIGH
 Please contact Knox County Schools Transportation and Zoning Department at (865) 594-1550 if you have questions.

County Commission: 8 Richie Beeler
 (at large seat 10) Larsen Jay
 (at large seat 11) Kim Frazier

School Board: 8 Mike McMillan

Please contact Knox County Election Commission at (865) 215-2480 if you have questions.

Disclaimer: KGIS makes no representation or warranty as to the accuracy of this map and its information nor to its fitness for use. Any user of this map product accepts the same AS IS, WITH ALL FAULTS, and assumes all responsibility for the use thereof, and further covenants and agrees to hold KGIS harmless from any damage, loss, or liability arising from any use of the map product. Independent verification of all information contained on this map should be obtained by any user.

Proprietary Info: The map products and databases on this Web Site have been copyrighted by the KGIS Policy Board. The KGIS Policy Board hereby reserves all rights thereto, and no portion of the products or databases on this Web Site may be reproduced in any form or by any means without the express written authorization of the KGIS Policy Board or its authorized agents.